

THIS DRAWING CONTAINS INFORMATION PROPRIETARY TO POSITRONIC AND ITS SUBSIDIARIES. POSITRONIC RELIEVES THE DATA ON THIS DRAWING TO BE RELIABLE. SINCE THE TECHNICAL INFORMATION IS SUBJECT TO CHANGE, THE USER EMPLOYS SUCH INFORMATION AT HIS OWN DISCRETION AND RISK. POSITRONIC ASSUMES NO RESPONSIBILITY FOR RESULTS OBTAINED OR DAMAGES INCURRED FROM USE OF SUCH INFORMATION IN WHOLE OR IN PART.

DATE		REV	REVISION RECORD	APP	DR	CK
10-14	16	NC	ECO 52967	BP	AD	BP

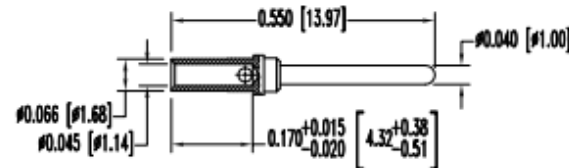
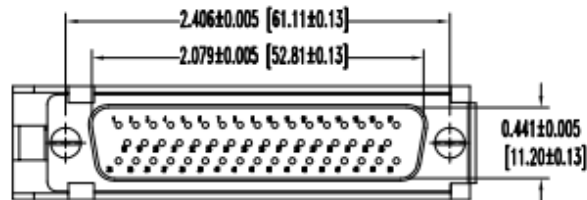
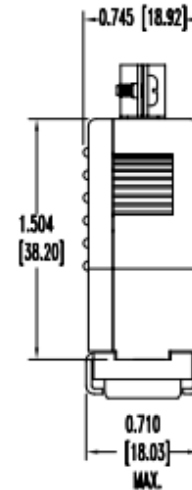
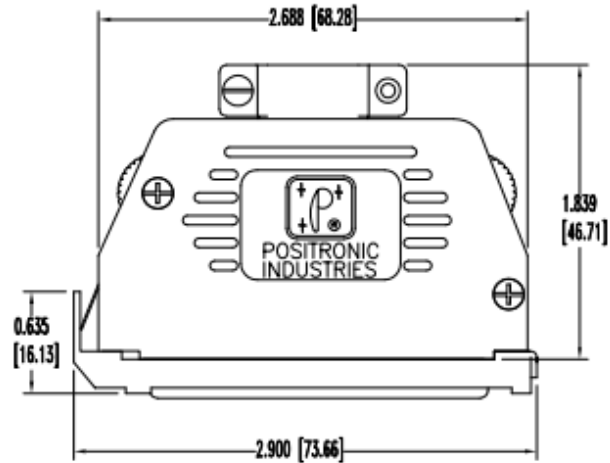

50X MALE CONTACT
ENLARGED

NOTES:

1. MATERIALS AND FINISHES:

- INSULATOR: GLASS FILLED DAP PER ASTM-D-5948, SDG-F, UL 94V-0, COLOR: GREEN.
- CONTACTS: PRECISION MACHINED COPPER ALLOY, GOLD FLASH OVER NICKEL PLATE.
- SHELLS: STEEL WITH T1M PLATE.
- HOOD: GLASS FILLED POLYESTER, UL 94V-0, COLOR: BLACK.
- LOCK ARM AND CABLE CLAMPS: STEEL WITH NICKEL PLATE.
- LOCK ARM SPRING: BERYLLIUM COPPER WITH NICKEL PLATE.
- CABLE CLAMP SCREWS: BRASS, ZINC PLATE WITH CHROMATE SEAL.
- SCREWS: STEEL, ZINC PLATE WITH CHROMATE SEAL.

2. DETAILED PRODUCT, MECHANICAL, AND ELECTRICAL INFORMATION IS AVAILABLE IN THE LATEST STANDARD DENSITY D-SUB PRODUCT PUBLICATION AT CONNECTPOSITRONIC.COM.

3. DIMENSIONS ARE IN INCHES [MILLIMETERS].

 POSITRONIC INDUSTRIES INC. www.connectpositronic.com		FSCM 26198	
RD SERIES		N.T.S.	AMOL B.
DECIMAL TOL. ± 0.015 [0.38]		APPROVED BY BP	
TITLE RD50M10JVLX			
DATE 10-14-16		DRAWING NUMBER SK19756	
ANGULAR TOL. $\pm 5^\circ$		REV. NC	