

**Серия ETD**

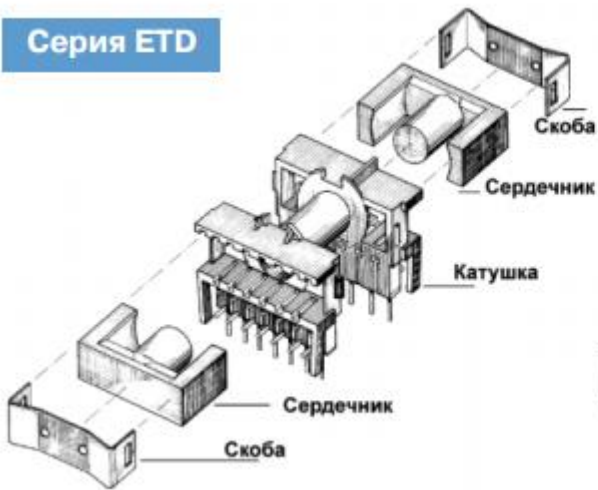

**Серия EFD**



**Type : EFD Cores (1)**

Ordering Code:



Shape:

Type:1

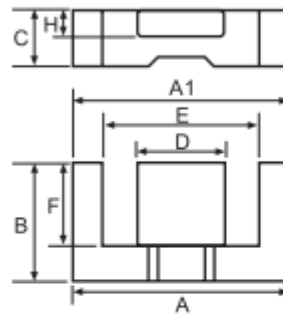

Type:2

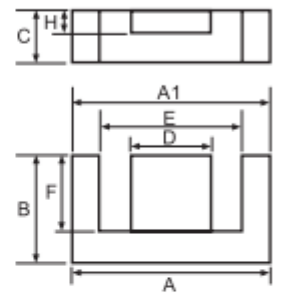

Type:3

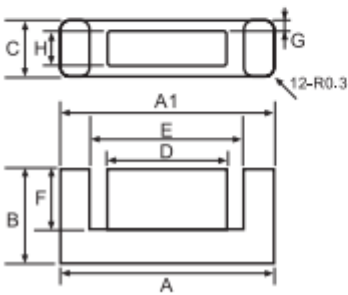

Type:4

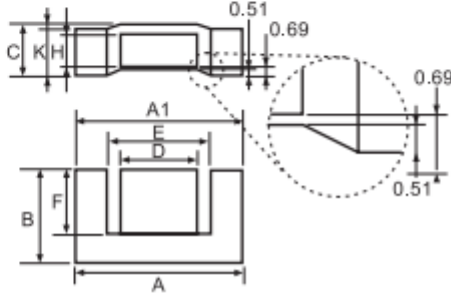

Type:5

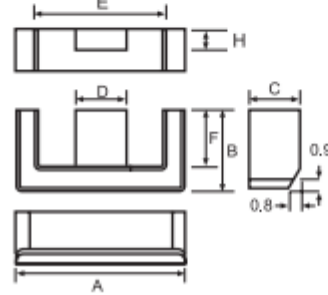

Type:6

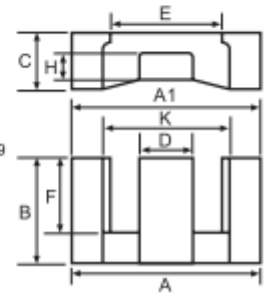

## ■ DIMENSIONS

CORES	DIMENSIONS (mm)										Type
	A	B	C	D	E	F	G	H	K	A-A1	
EFD6.2	6.25 ± 0.15	3.15 ± 0.10	2.50 ± 0.10	2.50 ± 0.10	4.85 ± 0.15	2.30 ± 0.10	-	1.25 ± 0.10	-	0.15max	2
EFD6.4	6.40 ± 0.15	3.70 ± 0.10	2.90 ± 0.10	2.35 ± 0.10	5.30 ± 0.15	2.90 ± 0.10	-	1.40 ± 0.10	-	-	2
EFD6.5	6.50 ± 0.15	3.65 ± 0.10	3.00 ± 0.10	2.50 ± 0.10	5.20 ± 0.15	2.85 ± 0.10	-	1.70 ± 0.10	-	-	2
EFD6.5-1	6.55 ± 0.15	3.65 ± 0.10	3.00 ± 0.10	2.50 ± 0.10	5.25 ± 0.15	2.85 ± 0.10	-	1.70 ± 0.10	-	0.15max	2
EFD7.5	7.50 ± 0.30	4.05 ± 0.15	2.30 ± 0.15	2.50 ± 0.15	5.70 ± 0.20	2.75 ± 0.15	-	1.15 ± 0.15	-	-	5
EFD8.0	8.00 ± 0.15	3.70 ± 0.10	1.90 ± 0.10	3.40 ± 0.10	5.90 min	2.30 ± 0.10	-	0.90 ± 0.10	-	0.15max	2
EFD9.2A	9.20 ± 0.20	4.50 ± 0.10	1.90 ± 0.10	5.10 ± 0.15	6.60 ± 0.15	3.10 ± 0.10	0.50 ± 0.10	0.90 ± 0.10	-	-	3
EFD9.5	9.60 ± 0.15	4.60 ± 0.10	2.20 ± 0.10	4.00 ± 0.10	7.35 ± 0.15	3.00 ± 0.10	-	1.15 ± 0.10	-	≤ 0.13mm	1
EFD9.8	9.80 ± 0.15	9.80 ± 0.10	2.50 ± 0.10	4.50 ± 0.10	7.40 ± 0.15	7.80 ± 0.10	-	1.31 ± 0.10	-	0.15max	2
EFD10.7	10.70 ± 0.20	6.50 ± 0.10	3.50 ± 0.15	3.20 ± 0.10	8.30 ± 0.15	5.15 ± 0.10	-	1.50 ± 0.10	-	-	2
EFD11.2A	11.20 <sup>+0.20</sup> / <sub>-0.25</sub>	5.70 ± 0.12	2.70 ± 0.20	4.90 <sup>+0.10</sup> / <sub>-0.15</sub>	8.70 ± 0.20	3.95 ± 0.10	-	1.40 <sup>+0.10</sup> / <sub>-0.15</sub>	-	-	2
EFD11.3	11.30 ± 0.20	6.70 ± 0.20	3.50 ± 0.15	3.20 ± 0.15	8.50 min	5.20 ± 0.10	-	1.50 ± 0.10	-	-	2
EFD11.7/13.6	11.75 ± 0.15	13.60 ± 0.15	2.38 ± 0.15	5.00 ± 0.10	8.65 ± 0.15	11.60 ± 0.10	-	1.50 ± 0.10	-	≤ 0.20mm	2
EFD12	12.50 ± 0.30	6.20 ± 0.10	3.50 ± 0.10	5.40 ± 0.15	9.00 ± 0.25	4.55 ± 0.15	-	2.00 ± 0.10	-	0.20max	1
EFD12.2A	12.20 ± 0.25	7.60 ± 0.20	3.50 ± 0.15	3.30 ± 0.15	9.80 ± 0.25	6.35 ± 0.15	-	2.00 ± 0.15	-	≤ 0.25mm	2
EFD12A/3.5	12.00 ± 0.20	7.70 ± 0.15	3.50 ± 0.15	3.20 ± 0.10	9.35 min	6.30 ± 0.15	-	1.50 ± 0.10	-	0.15max	2
EFD12.4B	12.40 <sup>+0.30</sup> / <sub>-0.20</sub>	6.05 ± 0.20	4.00 ± 0.10	5.15 ± 0.15	9.70min	4.60 ± 0.15	-	2.20 ± 0.10	-	-	2
EFD12.45	12.45 ± 0.25	6.20 ± 0.15	3.90 ± 0.08	5.80 ± 0.12	7.75 ± 0.15	4.05 ± 0.10	-	2.55 ± 0.05	3.50 ± 0.06	-	4
EFD12.7	12.75 ± 0.25	6.85 ± 0.15	3.30 ± 0.15	6.00 ± 0.10	9.35 ± 0.15	4.55 ± 0.15	-	1.85 ± 0.10	-	≤ 0.20mm	2
EFD12.7A	12.70 ± 0.20	10.60 ± 0.15	5.40 ± 0.15	4.50 <sup>+0.10</sup> / <sub>-0.15</sub>	8.90 <sup>+0.20</sup> / <sub>-0.10</sub>	8.20 ± 0.15	-	3.50 ± 0.10	-	0.15max	2
EFD13	13.20 ± 0.35	6.85 ± 0.15	2.85 ± 0.15	5.25 ± 0.15	9.60 <sup>+0.15</sup> / <sub>-0.25</sub>	4.80 ± 0.15	-	1.40 ± 0.10	-	≤ 0.30mm	1
EFD13.3	13.35 ± 0.25	5.65 ± 0.15	3.80 ± 0.15	6.65 ± 0.15	10.00 ± 0.20	3.80 ± 0.20	-	1.65 ± 0.10	10.40 ± 0.20	≤ 0.30mm	6
EFD13.5A	13.50 <sup>+0.20</sup> / <sub>-0.15</sub>	11.00 <sup>+0.15</sup> / <sub>-0.10</sub>	4.50 ± 0.10	5.30 ± 0.10	9.80 min	8.55 ± 0.10	-	3.00 ± 0.10	-	0.20max	2
EFD13.5B	13.50 <sup>+0.20</sup> / <sub>-0.15</sub>	11.55 <sup>+0.15</sup> / <sub>-0.10</sub>	3.80 ± 0.10	5.30 ± 0.10	9.80 min	9.05 ± 0.10	-	2.70 ± 0.10	-	0.20max	2
EFD13.8	14.00 ± 0.35	8.65 ± 0.15	3.35 ± 0.15	5.60 ± 0.15	10.60 ± 0.30	6.45 <sup>+0.15</sup> / <sub>-0.10</sub>	-	1.60 ± 0.10	-	≤ 0.20mm	1

## ■ EFFECTIVE PARAMETERS

CORES	EFFECTIVE PARAMETERS				
	C <sub>i</sub> (mm <sup>-1</sup> )	Le(mm)	Ae(mm <sup>2</sup> )	Ve(mm <sup>3</sup> )	Wt(g/set)
EFD6.2	4.47	14.26	3.19	45.49	0.27
EFD6.4	5.11	17.05	3.34	56.91	0.15
EFD6.5	4.25	16.77	3.95	66.24	0.73
EFD6.5-1	4.26	16.82	3.95	66.44	0.39
EFD7.5	4.98	17.15	3.44	59.07	0.40
EFD8.0	4.85	15.95	3.29	52.48	0.38
EFD9.2A	4.27	18.80	4.40	82.70	0.52
EFD9.5	4.06	20.10	4.80	97.50	0.56
EFD9.8	6.54	39.64	6.06	240.22	1.30
EFD10.7	4.87	28.02	5.75	161.12	1.14
EFD11.2A	3.60	25.05	6.96	174.40	0.98
EFD11.3	4.60	28.40	6.18	175.50	0.92
EFD11.7/13.6	7.57	56.28	7.43	418.16	2.10
EFD12	2.59	27.42	10.55	289.20	1.62
EFD12.2A	3.94	32.29	8.19	264.46	1.50
EFD12A/3.5	5.47	33.18	6.07	201.38	1.34
EFD12.4B	2.61	27.88	10.68	297.89	1.64
EFD12.45	1.66	25.60	15.40	394.20	2.10
EFD12.7	2.57	28.68	11.13	319.20	1.80
EFD12.7A	2.42	43.33	17.93	776.91	4.39
EFD13	3.57	29.28	8.18	239.50	1.53
EFD13.3	2.15	25.10	11.65	292.42	1.64
EFD13.5A	2.78	45.97	16.54	760.34	4.04
EFD13.5B	3.33	48.03	14.44	693.55	3.62
EFD13.8	3.75	36.98	9.84	363.80	2.04

