

Серия ETD

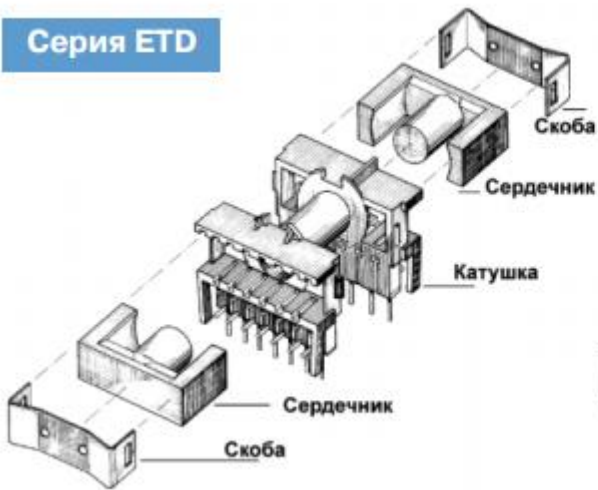

Серия EFD



Ordering Code:

P4	EFD20	G□
Material 材質	Core Size 品名	Gapped AL Value

Type:1

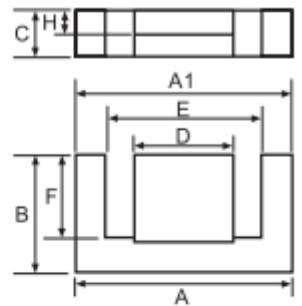

Type:2

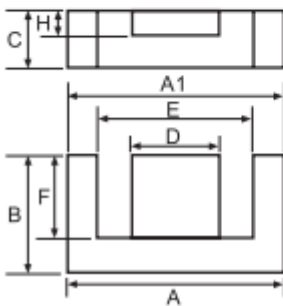

Type:3

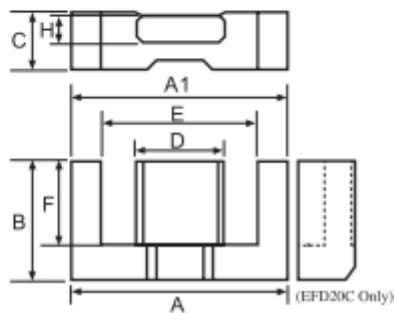

Type:4

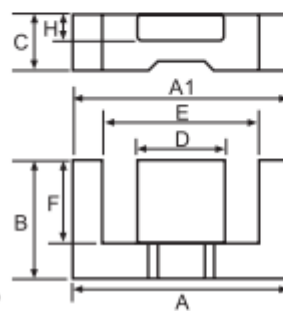

Type:5

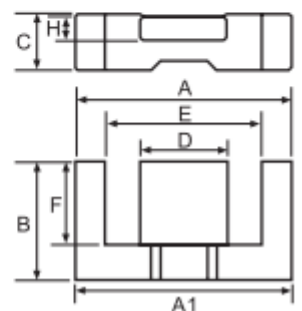

■ DIMENSIONS

CORES	DIMENSIONS (mm)								Type
	A	B	C	D	E	F	H	A-A1	
EFD20	20.00 ± 0.55	10.00 ± 0.15	6.65 ± 0.15	8.90 ± 0.20	15.40 ± 0.50	7.70 ± 0.25	3.60 ± 0.15	≤ 0.25mm	3
EFD20A	20.00 ± 0.55	11.60 ± 0.15	6.00 ± 0.15	8.90 ± 0.20	15.40 ± ^{0.20} / _{0.30}	9.30 ± ^{0.25} / _{0.20}	3.60 ± 0.15	≤ 0.20mm	3
EFD20B	20.00 ± 0.55	11.60 ± 0.15	5.40 ± 0.15	8.90 ± 0.20	15.40 ± ^{0.20} / _{0.30}	9.30 ± ^{0.25} / _{0.20}	3.60 ± 0.15	≤ 0.20mm	3
EFD20B/30	20.00 ± 0.55	15.00 ± 0.15	5.40 ± 0.15	8.90 ± 0.20	15.40 ± ^{0.20} / _{0.30}	12.70 ± ^{0.25} / _{0.20}	3.60 ± 0.15	≤ 0.20mm	3
EFD20C	20.00 ± 0.30	11.50 ± 0.15	5.60 ± 0.10	8.90 ± 0.20	15.40 ± 0.50	9.30 ± 0.15	3.60 ± 0.15	≤ 0.20mm	3
EFD20D	20.50 ± 0.40	10.00 ± 0.25	6.65 ± ^{0.20} / _{0.15}	8.90 ± 0.20	15.90 ± 0.30	7.70 ± 0.20	3.60 ± 0.15	≤ 0.20mm	3
EFD20E	20.00 ± 0.30	13.30 ± 0.20	5.80 ± 0.12	8.90 ± 0.20	15.40 ± 0.20	11.00 ± 0.20	3.50 ± 0.12	≤ 0.20mm	2
EFD20.3	20.30 ± 0.50	10.20 ± 0.15	6.00 ± 0.15	8.90 ± 0.20	15.70 ± 0.20	7.90 ± 0.20	3.60 ± 0.15	≤ 0.30mm	3
EFD20.6	20.60 ± 0.50	10.20 ± 0.15	6.60 ± 0.15	8.90 ± 0.20	16.70 ± ^{0.40} / _{0.30}	8.00 ± 0.15	3.70 ± 0.15	-	3
EFD20.7	20.70 ± 0.60	12.30 ± 0.20	4.15 ± 0.20	10.20 ± 0.25	15.80 ± ^{0.50} / _{0.30}	9.20 ± 0.20	2.05 ± 0.15	-	2
EFD21.4	21.40 ± 0.30	12.60 ± 0.20	6.00 ± 0.15	9.50 ± 0.15	16.10min	10.00 ± 0.20	3.40 ± 0.10	≤ 0.25mm	2
EFD21.5	21.50 ± 0.40	20.50 ± 0.20	4.65 ± 0.15	8.20 ± 0.15	14.20min	17.55 ± 0.15	2.90 ± 0.10	-	1
EFD22	22.00 ± 0.30	14.50 ± 0.15	7.40 ± 0.15	9.60 ± 0.15	16.00 ± 0.30	11.50 ± 0.15	4.20 ± 0.15	≤ 0.25mm	4
EFD22A	22.00 ± 0.50	16.30 ± 0.40	4.36 ± 0.25	10.00 ± 0.20	16.90 ± 0.50	13.90min	1.91 ± 0.15	0.30max	2
EFD22.5A	22.50 ± 0.60	12.00 ± 0.20	4.00 ± 0.20	11.00 ± 0.25	17.00 ± 0.40	9.35 ± 0.20	1.90 ± 0.15	-	2
EFD23.6	23.60 ± 0.40	14.40 ± 0.20	4.00 ± 0.20	11.00 ± 0.25	17.70min	11.60 ± 0.20	1.90 ± 0.20	-	2
EFD25	25.00 ± 0.65	12.50 ± 0.15	9.10 ± 0.20	11.40 ± 0.20	18.70 ± 0.60	9.30 ± 0.25	5.20 ± 0.15	≤ 0.30mm	3
EFD25A	25.05 ± 0.65	12.60 ± 0.20	12.45 ± 0.25	8.80 ± 0.25	19.20 ± 0.40	9.55 ± 0.25	8.30 ± 0.30	-	2
EFD25B	25.00 ± 0.65	12.50 ± 0.15	9.10 ± 0.20	11.40 ± 0.20	18.70 ± 0.60	9.30 ± 0.25	5.20 ± 0.15	-	3
EFD26.3	26.30 ± 0.50	12.70 ± 0.20	9.10 ± 0.20	11.30 ± 0.20	20.00min	9.50 ± 0.20	5.15 ± 0.15	-	5
EFD28.7	28.70 ± 0.40	14.90 ± 0.25	2.45 ± 0.10	14.80 ± 0.15	21.50 ± 0.35	11.30 ± 0.20	1.20 ± 0.10	≤ 0.30mm	2
EFD30	30.00 ± 0.80	15.00 ± 0.30	9.10 ± 0.30	14.60 ± 0.30	22.40 ± 0.75	11.20 ± 0.30	4.90 ± 0.25	-	1
EFD31	31.00 ± 0.45	18.00 ± 0.25	6.50 ± 0.20	14.00 ± 0.25	21.90 ± 0.40	13.50 ± 0.25	3.90 ± 0.20	-	2
EFD31.2	31.20 ± 0.50	15.25 ± 0.15	9.00 ± 0.20	14.40 ± 0.25	23.20 ± 0.40	11.30 ± 0.15	4.90 ± 0.15	-	3
EFD31.2B	31.20 ± 0.50	15.20 ± 0.20	9.00 ± 0.20	14.60 ± 0.30	23.80min	11.40 ± 0.20	4.90 ± 0.20	-	5
EFD31.4	31.40 ± 0.50	15.00 ± 0.20	9.10 ± 0.20	14.60 ± 0.25	23.40min	11.30 ± 0.20	4.90 ± 0.15	-	3
EFD31.4A	31.40 ± 0.60	15.50 ± 0.30	9.00 ± 0.20	14.60 ± 0.25	24.60min	11.70 ± 0.20	4.90 ± 0.20	-	5
FD31.8	31.80 ± 0.50	22.00 ± 0.15	5.10 ± 0.20	15.35 ± 0.40	21.60min	17.00 ± 0.15	3.15 ± 0.15	≤ 0.40mm	2

■ EFFECTIVE PARAMETERS

CORES	EFFECTIVE PARAMETERS				
	C _i (mm ⁻¹)	Le(mm)	Ae(mm ²)	Ve(mm ³)	Wt(g/set)
EFD20	1.59	45.49	28.50	1296.40	6.88
EFD20A	1.89	51.76	27.27	1411.49	7.66
EFD20B	2.00	51.46	25.64	1319.43	6.94
EFD20B/30	2.49	64.80	25.99	1684.15	8.92
EFD20C	1.98	51.22	25.84	1323.52	7.00
EFD20D	1.61	45.97	28.42	1306.40	6.90
EFD20E	2.19	58.48	26.65	1558.49	6.88
EFD20.3	1.72	46.02	27.88	1283.06	7.00
EFD20.6	1.78	47.40	26.59	1260.14	6.80
EFD20.7	2.53	52.78	20.84	1099.77	6.28
EFD21.4	1.88	55.76	29.66	1653.84	9.24
EFD21.5	3.16	84.57	26.75	2262.25	12.40
EFD22	1.57	62.52	39.94	2497.05	13.90
EFD22A	3.66	70.97	19.41	1377.87	7.67
EFD22.5A	2.53	54.00	21.30	1150.20	6.14
EFD23.6	3.02	63.32	20.97	1328.00	7.50
EFD25	1.03	55.81	53.92	3009.20	16.12
EFD25A	0.80	59.00	74.00	4370.00	22.40
EFD25B	1.04	55.81	53.92	3009.28	16.12
EFD26.3	1.05	57.80	54.83	3169.59	16.20
EFD28.7	4.03	65.02	16.10	1046.82	6.06
EFD30	0.98	66.02	67.52	4457.67	25.08
EFD31	1.44	77.23	53.56	4135.91	23.00
EFD31.2	0.99	67.85	68.52	4649.28	24.28
EFD31.2B	1.03	68.23	66.27	4521.52	25.24
EFD31.4	1.07	67.72	63.48	4298.64	25.40
EFD31.4A	1.11	69.62	62.71	4366.06	23.50
EFD31.8	1.91	91.32	47.77	4362.36	23.26

